



505.821.6964  
800.937.6925

www.rplighting.com  
royal@rplighting.com

4931 Paseo Del Norte NE  
Albuquerque, NM 87113

• **Five Years Limited Warranty** •

RP Lighting warrants this product to be free from defects in material and workmanship for five years from the original date of purchase by the consumer. This warranty is limited to the counter replacement at the time of purchase with the original receipt. We will not be liable for the loss or damages of any kind, incidental or consequential damages of any kind, whether based on negligence and/or arising in connection with the sale, use or repair of the product claimed to be defective. Some states do not allow the exclusion or limitation of incidental or consequential damages so above limitation may not apply to you. This warranty gives you specific legal right and you may also have other rights, which vary from state to state. Misuse, improper installation, accidental damages or modifications will void warranty.



## INSTALLATION INSTRUCTIONS

# LED CEILING MOUNT LIGHT

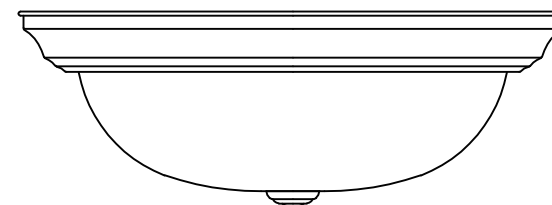

Model	Size	Watts	Input Volt.	CCT	Dimmable
4347-11-3K	11 <sup>1</sup> / <sub>4</sub> " X 4 <sup>1</sup> / <sub>2</sub> "	15W	120V	3000K	Yes
4347-13-3K	13" X 5 <sup>1</sup> / <sub>8</sub> "	20W	120V	3000K	Yes
4347-15-3K	15" X 5 <sup>3</sup> / <sub>8</sub> "	25W	120V	3000K	Yes

## SAFETY INFORMATION

- ⚠ WARNING** – Turn off the main power at the circuit breaker before installing and servicing the fixture to prevent possible injury from electric shock.
- All electrical connections must be in accordance with local and National Electrical Code (N.E.C.) standards.
  - Commercial installation, service and maintenance of luminaires should be performed by a qualified licensed electrician.

## ASSEMBLY & INSTALLATION

Carefully unpack the fixture. Lay out all parts on a clean surface and make sure there is no parts missing.

- Before installing, present the NIPPLE (16) length:
  - Thread the HEX NUT (14) onto the STEM (16), and screw the STEM (16) into the BUSHING (15) on the FIXTURE PAN (12) a minimum of four turns.
  - Place the center holes of the GLASS SHADE (17) over the STEM (16) and adjust the STEM (16) so that it protrudes out of the GLASS SHADE (17) or CAP (19) 1/4". Remove the GLASS SHADE (17) and secure the STEM (16) in place by tightening the HEX NUT (14).
- Pull the SUPPLY WIRES (5 & 6) and the HOUSE GROUND WIRE (7) out from the OUTLET BOX (1) and attach the MOUNTING BRACKET (2) to the OUTLET BOX(1) using the slotted holes on the MOUNTING BRACKET (2) and the MOUNTING SCREWS (3) provided.
- Thread the FIXTURE SCREWS (4) two full turns into the appropriate threaded holes in the MOUNTING BRACKET (2). (Check the MOUNTING BRACKET (2) against the fixture KEY HOLE SLOTS (13) to ensure proper fit.)
- See FIG. 4 to make electrical connections by using WIRE NUTS (11).
- Carefully tuck all wiring back into the OUTLET BOX(1). Locate the FIXTURE PAN (12) over the OUTLET BOX (1), positioning the FIXTURE SCREWS (4) heads through the large openings of the KEY HOLE SLOTS (13). Rotate the FIXTURE PAN (12) to seat the screws, and tighten securely. (See FIG. 2 )
- INSTALL THE SHADE. Place the center hole of the GLASS SHADE (17) over the STEM (16) and secure the GLASS SHADE (17) with the FINIAL KNOB (18) or secure the GLAS SHADE (17) and CAP (19) with the FINIAL KNOB (18) ( See FIG . 3 ).

INSTALLATION IS NOW COMPLETED

P1.

**Dimming-** This product is compatible with most common residential type dimmers, dimming performance depends on dimmers.



### Recommended Dimmers:

- Lutron MACL-153M, Lutron DVL-153P, Lutron SCL-153P,
- Leviton IPL06-10Z, Leviton 6674-POW

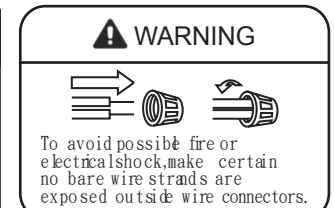
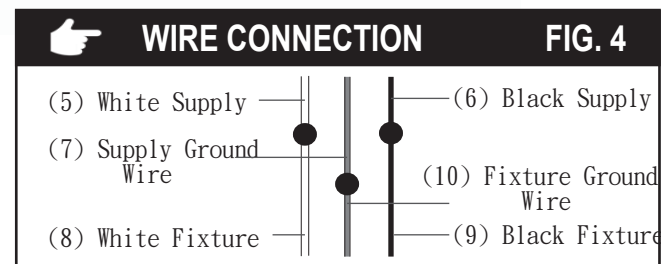
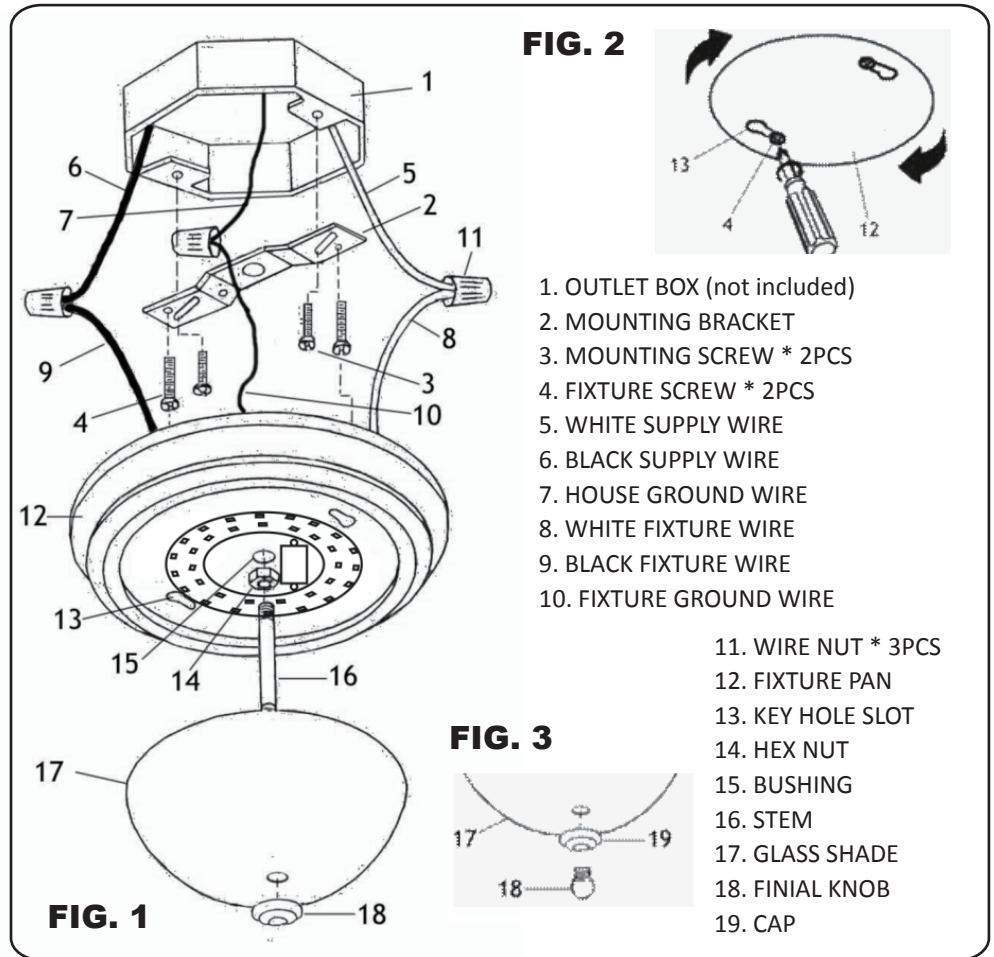

P2.